

RANGE 2**FM - NFPA - OSHA**

FM SAFETY CABINETS for flammable products

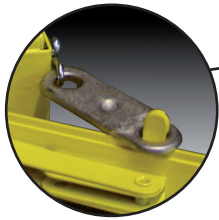

Fusible links hold doors wide open and melt at 74°C for automatic closure⁽¹⁾

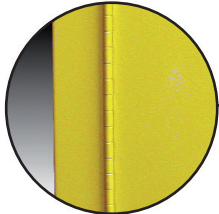

Continuous piano hinge



Vent with built-in flame arresters



SC45 *



Adjustable shelves

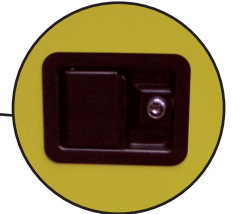

Integrated locking handle

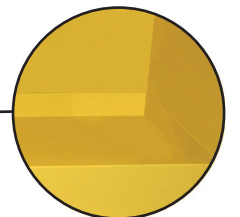

Liquid-tight containment sump

DIRECTIVES & NORMS

- In as per NFPA (National Fire Protection Association), OSHA (Occupational Safety and Health Administration), and FM (Factory Mutual international) regulations.

ADVANTAGES

- Sturdy construction
- Integrated locking handle.
- Cabinets with self-closing doors. The fusible links hold doors wide open and melt at 74°C for automatic closure⁽¹⁾.
- Continuous piano hinge provides smooth closure.
- Many models are available.

All FM approved cabinets are recommended by the U.S insurance companies.

PASSIVE SECURITY

- Built in double wall steel with 38 mm of insulating air space.
- Yellow epoxy paint.
- Adjustable shelves.
- 50 mm liquid-tight containment sump.
- Built in grounding connector.

ACTIVE SECURITY

- Lateral high and low vent Ø 2" (50mm) with flame arresters.
- Continuous piano hinge.
- Manual or self-closing doors.
- 3 points lock with fail-safe closing mechanism and locking handle.
- Key locking system.

OPTIONS

- Additional shelf.
- Absorbing carpets (ref.JF10).
- Ventilation or filtration boxes.

⁽¹⁾On self-closing models

RANGE 2

FM - NFPA - OSHA



P/N	Door types	Description	Out. dimension H x W x D (mm)	In. dimension H x W x D (mm)	Storage capacity (L)	Containment capacity (L)	Number of shelves	Maximum load by shelf ⁽³⁾ (kg)	W. (kg)
MB04	Manual	Under-bench cabinet with 1 door	559 x 432 x 432	465 x 345 x 360	15	6	1	159	25,9
SB04	Self-closing								32
MB12	Manual	Working cover cabinet with 1 door	889 x 591 x 457	795 x 510 x 390	45	10	1	159	46,7
SB12	Self-closing								67
ES12	-	Additional shelf for 45L cabinet							3
MB18	Manual	Under-bench cabinet with 2 doors	610 x 1092 x 457	515 x 1005 x 390	64	20	1	159	57,2
SB18	Self-closing								78
ES18	-	Additional shelf for 64L cabinet							4
MB22	Manual	Tall cabinet with 1 door	1651 x 585 x 460	1560 x 500 x 390	83	10	3	159	85,7
SB22	Self-closing								92
ES22	-	Additional shelf for 83L cabinet							2
MB30	Manual	Working cover cabinet with 2 doors	1118 x 1092 x 457	1025 x 1005 x 390	113	20	1	159	87,4
SB30	Self-closing								108
ES30	-	Additional shelf for 113L cabinet							4
MC45	Manual	Tall cabinet with 2 doors	1651 x 1092 x 457	1560 x 1005 x 390	170	20	2	159	120,7
SC45	Self-closing								143
ES45	-	Additional shelf for 170L cabinet							4
MC60	Manual	Tall cabinet with 2 doors	1651 x 864 x 864	1560 x 770 x 780	228	30	2	159	148,8
SC60	Self-closing								173
ES60	-	Additional shelf for 228L cabinet							8
MC90 ⁽²⁾	Manual	Tall cabinet with 2 doors	1651 x 1092 x 864	1560 x 1020 x 780	340	40	2	159	176,9
SC90 ⁽²⁾	Self-closing								223
ES90 ⁽²⁾	-	Additional shelf for 340L cabinet							10

⁽²⁾Model not on stock and not shown on the picture ⁽³⁾ Evenly distributed



Some models of Range 2 FM safety cabinets are designed to stack on Range 4 cabinets. Contact-us for more information.

Recycling air box Labopur H50

To protect the users health and to improve the life cycle and the safety of your cabinet, we recommend to install an exhausting system. Contact us for additional information.



The manufacturer reserves the right to discontinue or change specifications or designs at any time without notice and without incurring obligations. 07/2019

Flammable cabinets

Corrosive cabinets

Toxic cabinets and multirisk

Pesticide range

Fume hoods, filtering cabinets - Ventilation

Containment and Cans

File cabinets Anti-fire equipments

Showers and first-aid equipments